

Part No.	Description
MMS-FX	Top mount auxiliary contact c/w 1N/O 1N/C
MMS-LX	Side mount (left side) auxiliary contact c/w 1N/O 1N/C
MMS-LA	Side mount (left side) trip indicator c/w 1N/O 1N/C
MMS-RS	Side mount (left side) shunt release c/w 1N/O 1N/C
MMS-RU	Side mount (right side) under voltage release c/w 1N/O 1N/C
DA-32 SA	Connection kit for MC-32/MC-40 contactors to MMS-32S
DA-32 HA	Connection kit for MC-32/MC-40 contactors to MMS-32H
PB-322	Commoning bus comb for connection of 2×MMS-32
PB-323	Commoning bus comb for connection of 3×MMS-32

Auxiliaries

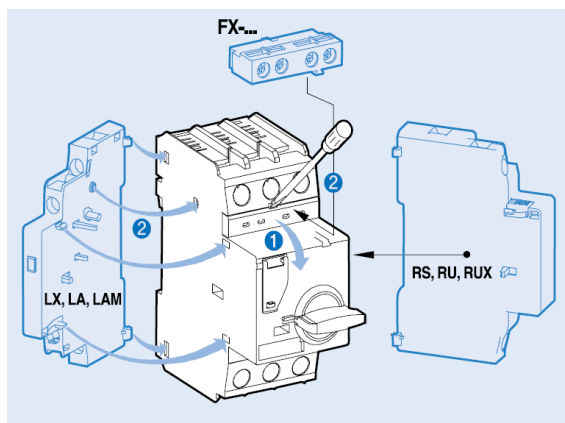
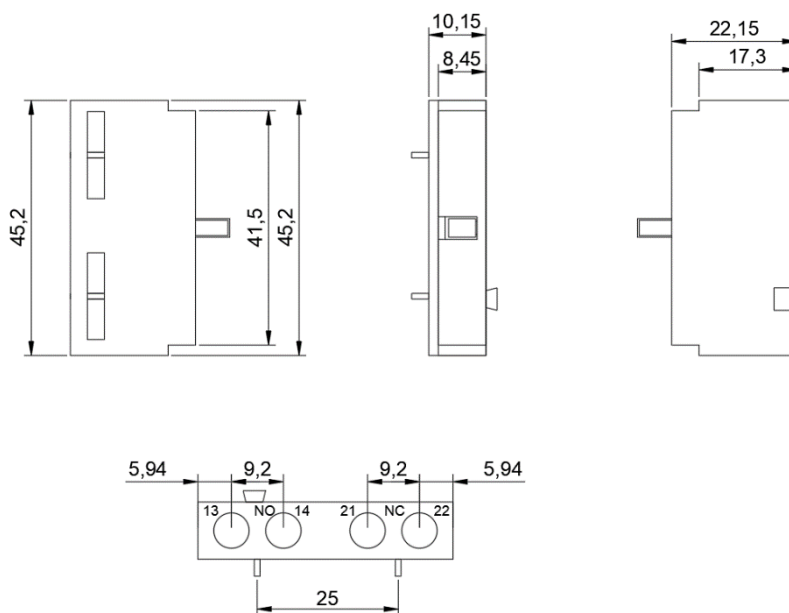
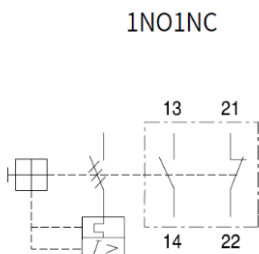

Figure 1 Auxiliaries fit directly on to the starter

MMS-FX Auxiliary Switch

- Front mounting
- 2-pole
- One front mounting module per circuit breaker



MMS-LA Any Alarm Trip Switch

- Operates in case of a trip
- Side mounting on the left
- 2-pole
- Set LA first in case of using LX together.

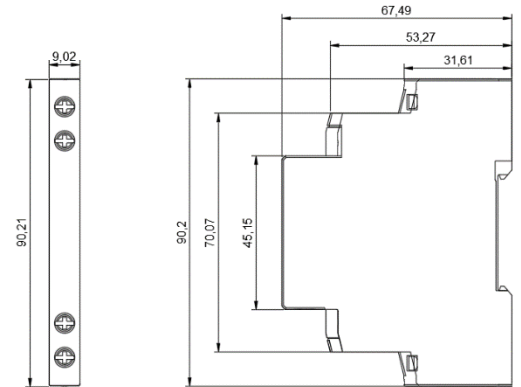
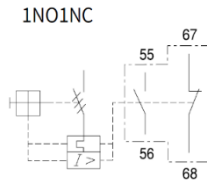

MMS-LX Any Alarm Trip Switch

- Side mounting on the left
- 2-pole
- One side mounting module per circuit breaker

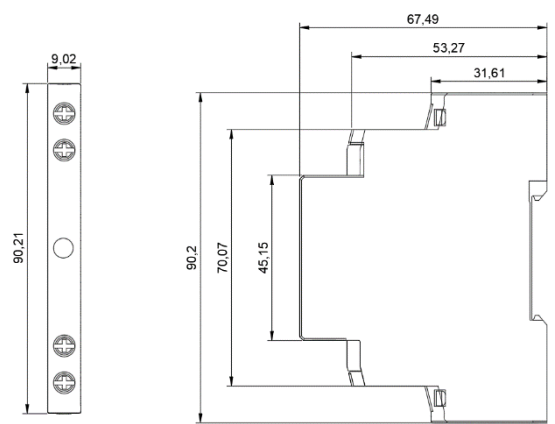
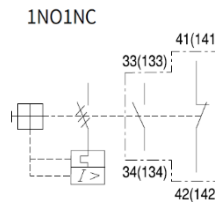

MMS-RS Shunt Release

- Side mounting on the right
- One side mounting module per circuit breaker.
- Can not be used with MSS-RU

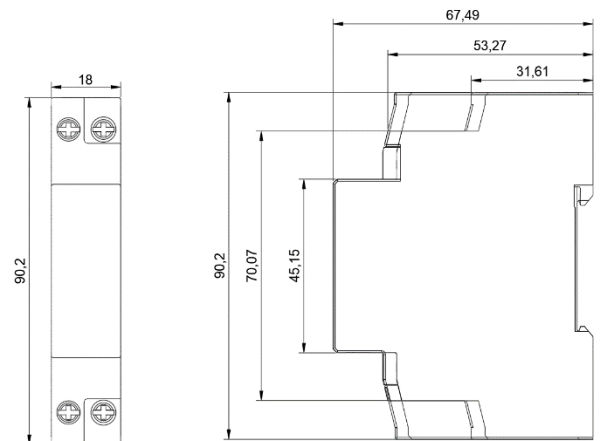
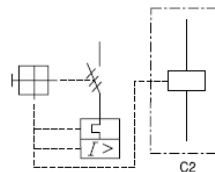

MMS-RU Any Alarm Trip Switch

- Side mounting on the right
- One side mounting module per circuit breaker.
- Can not be used with MSS-RS

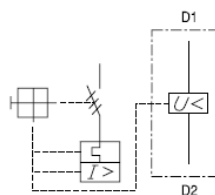

PB-322, PB-323 Commoning Bar Combs

- PB-322; used for connecting 2 MMS units in series.
- PB-323; used for connecting 3 MMS units in series

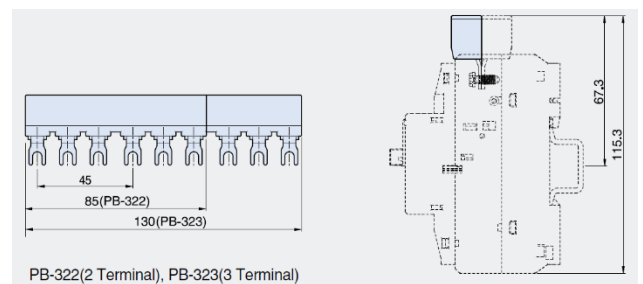

DA-32SA, DA-32HA Mini Contactor Adapter

Adaptor	MMS	Contactor model
DA-32SA	MMS-32S	MC-9~32 (AC)
DA-32HA	MMS-32H	MC-9~32 (AC)

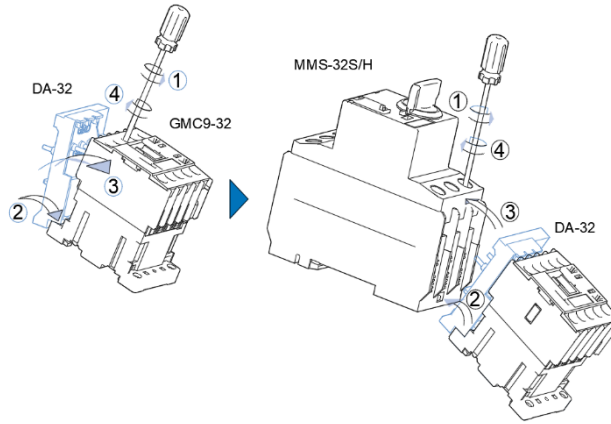

DA-32SA Contactor Adapter

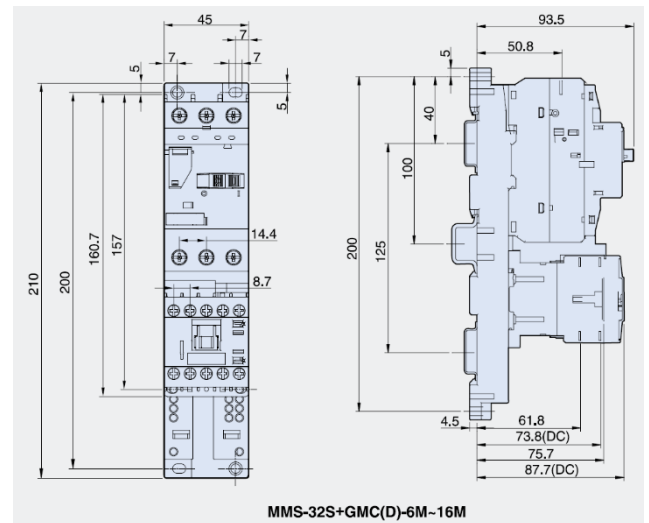
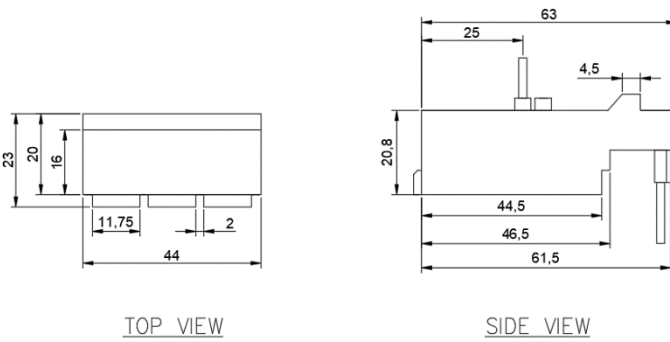

DA-32HA Contactor Adapter

